

The future is now

Thank you for believing in our vision of the smart home and congratulations to a fantastic smart home experience.

If this is your first time with Animus Home, please follow this quick 3-step installation to get yourself connected correctly.



STILL NEED HELP?
Visit our support page at
animushome.com/support



Package Content

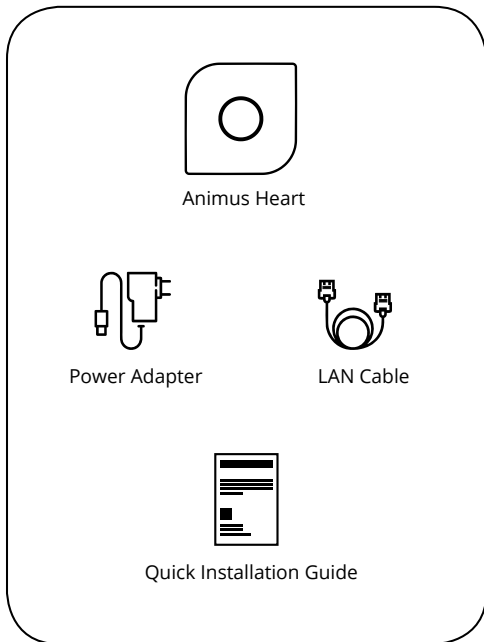

Quick Installation

1 Connect your Animus Heart to your Internet router by using the included LAN-cable.

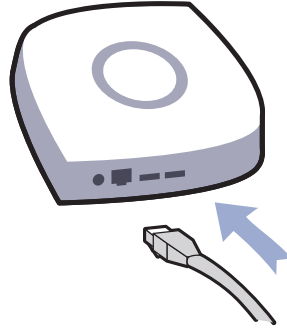

Animus Heart works best if installed in a central location to where your smart devices will be placed.

2 Now connect your Animus Heart to a power source by using the included power adapter.

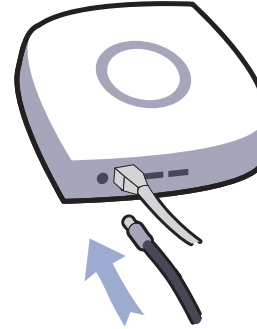

Avoid installing the Animus Heart near or inside sources of metal, radio or electromagnetic interference.

3 Finally download the **Animus Home Mobile app** on the App Store or the Android Market and follow the simple guide in the app.



You're now ready to enjoy your Animus Home!

hApp[®] Boosted

Customize your home with simple, ready-made, smart solutions. If there is no hApp for what you need, it is a hApp just waiting to be made by the developer community.

Read more about hApps on;
animushome.com/happ



Simple To Use

Clean and simple in every aspect. We removed all confusion by keeping it free from buttons.

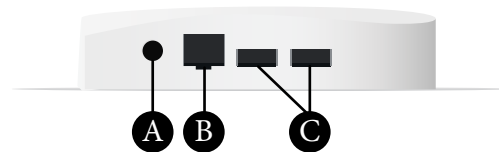

- A. Power** Regular 2.1mm power connection to be used with the included adapter and cable.
- B. LAN** Provides connectivity to the network by ethernet cable (optional).
- C. USB (2)** Provides connection through USB for other devices, e.g. external storage.

Feedback

Animus Heart has an integrated halo (status light) to let you know the status of your smart home.

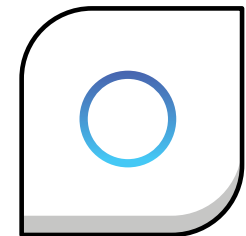

Flip this over for more information.



FAQ

I can not find my Animus Heart / I do not have a local IP address!

Be sure that your mobile phone is connected to your home internet/local area network (LAN) before trying to find your Heart. Still can't get it to work, visit wiki.animushome.com

Where can I talk to a developer about a new hApp idea or update?

If you already installed a hApp, there may be ways to contact that developer through the hApp's interface. Otherwise we also have a community forum at; community.animushome.com

If I want to create and develop a hApp, where should I start?

We help guide you with just that if you look for how to get started with developing at; animushome.com/developer

Legal notices

Notice of Origin

The producer of this device and the publisher of this document is Animus Home AB, Anckargripsgatan 3, SE-211 19 Malmö, Sweden.

Notices on Intellectual Property Rights

© 2015-2017 Animus Home AB
Trademarks: 015768757, 015768781, 87235324.
Design Patents: 003463322-0001

Warranty and Service

This product is provided to its end-users through a network of distributors, resellers and the Animus Home online store. Contact your point of purchase for warranty claims and to obtain service and support related to the product.

Limitation of Liability

For consumers, the limitations set out herein shall only apply to the extent permitted by applicable consumer protection legislation. You expressly agree that your use of, or inability to use, the goods and services is at your sole risk. The goods, services and products delivered to you through the service are (except as expressly stated by us) provided 'as is' and 'as available' for your use, without any representation, warranties or conditions of any kind, either express or implied, including all implied warranties or conditions of merchantability, merchantable quality, fitness for a particular purpose, durability, title,

Factory Reset

If you need to start over with a factory reset of your Animus Heart you will need to set it to recovery mode first.

Read all the steps first before attempting anything!

1. Unplug the power to your Animus Heart.
2. Plug the power back in, wait for the LED ring to show **light blue** for the **second time** (around 6s), then unplug the power again. This enables recovery mode for the next time your Heart boots up.
3. Plug the power back in and wait until the Halo (LED indicator) shows orange. If the default blue light is shown after a minute your Heart is not in recovery mode, please redo the first two steps.
4. Open a web browser and enter the IP of your Heart. Scroll down to Firmware Reset and choose to do a factory reset there.

and non-infringement. Animus Home does not carry direct or indirect responsibility for incompatibility, delivery delays, downtime of services or data loss. Animus Home accepts no liability to the customer whether in contract, tort (including negligence) or otherwise for of any of the following losses or damages: (a) loss of profit arising directly or indirectly; (b) loss of business or of revenues arising either directly or indirectly; (c) any losses, damages, costs or expenses to the extent that these are indirect losses. The sum payable by Animus Home to the customer in respect of all claims whether arising for breach of contract, in tort (including negligence) or otherwise shall not exceed the sum actually paid to Animus Home from the consumer for the goods or services in question. The limitations set out herein shall not apply if we have acted with gross negligence or intent.

Governing Law

All attempts to fraud are reported to the police. Animus Home reserves the right to cancel a purchase if any suspicion of crime is raised. These Terms and Conditions are governed by Swedish law, explicitly excluding the United Nations Convention on the International Sale of Goods (CISG). Any dispute shall be settled in a Swedish public court with the District Court of Malmö being the first instance.

WARNING: Service by authorized service personnel only. Warranty terms do not apply if the product is opened.

This page is intentionally left blank.

CE Declaration of Conformity

Development and assembly

Animus Home AB
Anckargripsgatan 3, SE-211 19 Malmö, Sweden

Herewith declare that:

This product is in conformity with provisions applied LVD (2014/35/EU) and EMC (2014/30/EU).

The product is in conformity with the essential requirements of Article 3.1 (a) the protection of the health and safety, and 3.1 (b), 3.2 of R&TTE Directive 1999/5/EC or RED 2014/53/EU

Important safety instructions

- Read, keep and follow these instructions.
- Read all warnings.
- Do not use this product near water or expose the product to dripping or splashing of any water or liquid.
- Clean only with dry cloth.
- Do not install or keep near any heat sources such as radiators, heat registers, stoves or other apparatus (including amplifiers) that produce heat.
- Only use attachments and accessories specified by the manufacturer.

Regulatory information



Disposal of Electrical and Electronic Equipment

The symbol informs about collection, recycling and recovery of electrical goods and that they shall not be treated as household waste. These goods should be handed over to an appropriate collection point. By handing it over to a collection point you help prevent potential negative impact on environment and human health. You also contribute in using our limited natural resources more efficiently.



The return arrows show that the material can be recycled.

Animus Heart
Animus Home AB

AHG1



Specifications are subject to change without notice. No part of the specifications may be reproduced in any form without permission of Animus Home AB.

Copyright 2017 Animus Home AB. All rights reserved.



Made in Sweden

www.animushome.com